



4184 E. Conant St.
Long Beach, CA 90808
Tel. 888-900-1002
Fax. 310-900-1088
www.turboairinc.net

Project :

Model # :

Item # :

Qty :

Approval :

Unit Cooler

Model : ADR112AE(OX, NX, OM, NM)



≡ FEATURES / BENEFITS ≡

- Blue anti-corrosion-fin increases the life span of the coil.
- Air-pass guard is located at the bottom of the coil to improve heat exchange rate.
- Easy to replace defrost heater (LED model).
- Corrugated fin is used to increase heat exchanges rate by expanding the surface area.
- Even in confined space, all parts can be reached easily by opening the front cover.
- Location of power connector makes replacement of motor convenient.
- Seamless inner groove copper tube increases the heat exchange rate by reducing the space between the fin and copper tube.
- Venturi type distributor and precise orifice hole are used to minimize the pressure drop and maximize the freezing capacity respectively.
- Even in confined space, all parts can be reached easily by opening the front cover.
- Thermostat is installed to prevent over temperature on heater.
- Circuit opens automatically over 70°F.
- Parts available:
Expansion Valve (Sporlan) (Factory Pre-mounted)
Solenoid Valve (Sporlan) (Factory Pre-mounted)
Thermostat (Johnson Control) (Shipped Loose)
- The spiral fan guard enables cold air to be delivered efficiently and thoroughly.
- The protruding fan and motor placement substantially reduce vibration and noise.
- EC Motor (Dual Speed) for high energy efficiency.
- Anti-oxidizing stainless steel mounting and bolts.

Unit Cooler

Model : ADR112AE(OX, NX, OM, NM)

ADR AIR DEFROST MODEL 60HZ WITH EC MOTOR (DUAL SPEED)

Capacity (R-404A)				Capacity (R-448A / R-449A)				Fan Data		
10°F / 6°C TD 25°F / -4°C SST		14°F / 8°C TD 21°F / -6°C SST		10°F / 6°C TD 25°F / -4°C SST		14°F / 8°C TD 21°F / -6°C SST		CFM/m³H		No.
BTUH	Watts	BTUH	Watts	BTUH	Watts	BTUH	Watts			
11280	3304	14763	4324	11234	3290	14694	4303	1544	2623	2

EC Motor Data			Connections (Inches)				Approx. Net Weight (Lbs. / Kg)	AWEF Value	
HP	Total Amps	Watts	COIL INLET	SUCTION	EQUALIZER	DRAIN		R-404A	R-448A / R-449A
115V 1Ph 60Hz									
1/25	1.50	50	1/2 OD	5/8 ID	1/4 OD	3/4 MPT	48 / 22	9	9

Design and specifications subject to change without notice

ADR112AEOX: R404A TXV "SBFSE-A-C" (Inlet: 3/8", Outlet: 1/2") Pre-installed

ADR112AENX: R448A/R449A TXV "SBFDE-A-C" (Inlet: 3/8", Outlet: 1/2") Pre-installed

ADR112AEOM: R404A TXV "SBFSE-A-C" (Inlet: 3/8", Outlet: 1/2") & LLSV "E3S130" (3/8") Pre-installed

ADR112AENM: R448A/R449A TXV "SBFDE-A-C" (Inlet: 3/8", Outlet: 1/2") & LLSV "E3S130" (3/8") Pre-installed

■ **WARRANTY : 1 Year Fan Motor and Parts Warranty**

PLAN VIEW

(unit : inch)

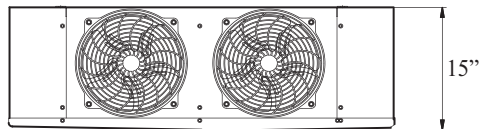

3/4" MPT (14NPS)
Drain Connection

FRONT VIEW

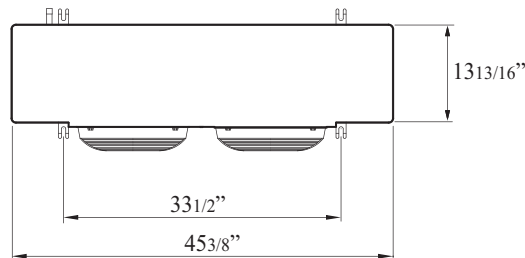

TOP VIEW

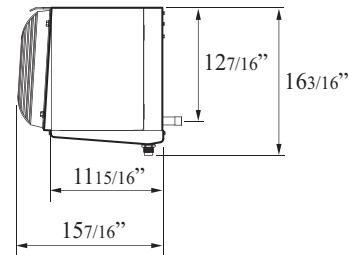

SIDE VIEW



■ Toll Free: 888-900-1002

Turbo air REFRIGERATOR MANUFACTURER

GERMAN KNIFE

RADIANCE

Turbo air REFRIGERATION SYSTEM

texaking

"Subject to change without notice" will allow Turbo Air to not be liable for small changes such as amperage, size or any other issue that someone would blame on us.